



Included Elevation A1



Optional Elevation B2



Optional Elevation C3



Optional Elevation D4



Optional Elevation E5



# Cooper's Bay

Harbour Series

**KENT** *homes*  
A SMARTER WAY TO A LUXURY HOME

-  2,262 heated sq ft
- 2,503 heated sq ft with opt bonus room
- 565 garage sq ft
- 480 covered outdoor living sq ft

 3 bedroom

 3 bath

 55' w x 70' d

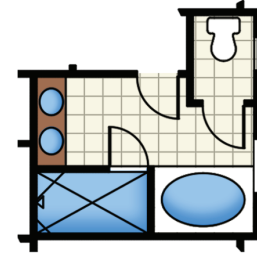

OPTIONAL MASTER BATH

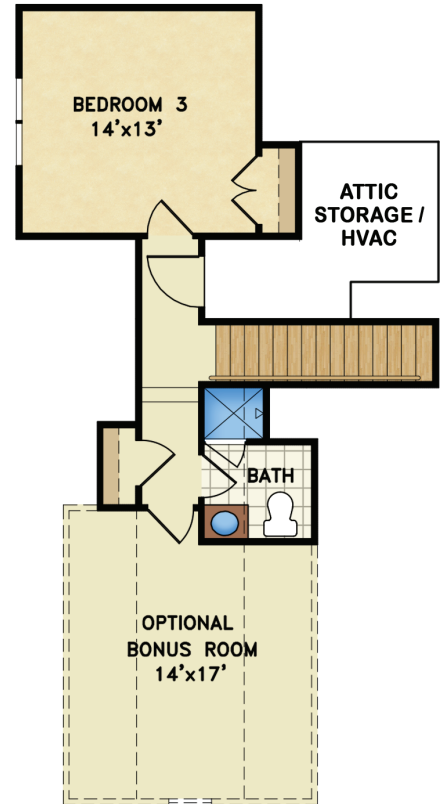

Optional Bonus Room  
241 sq. ft.