



Shown: Cruz Bay, Elevation A



Cruz Bay

The Cruz Bay offers beautiful West Indies-inspired architecture with a great open floor plan. A spacious kitchen with a walk-in pantry and entertaining island opens up to a dining room and great room with tray ceilings. Expansive doors lead out to a large screened loggia with adjacent patio to enjoy the surrounding nature setting. A private master suite features his and hers walk-in closets, his and hers vanities, and a large his and hers spa-like walk-in shower. A study, two guest bedrooms, and a second floor optional bonus room and bath allows for plenty of space and storage.



Elevation A



Elevation B



Elevation C

KENT *homes*

A SMARTER WAY TO A LUXURY HOME

Visit our Design Center today at 1721 Allens Lane, Suite 202, Wilmington, NC 28403
 toll free (877) 256 5313 p (910) 256 5313 f (910) 256 5302 www.kenthomes.net





Cruz Bay



Elevation A



Elevation B



Elevation C

KENT *homes*
A SMARTER WAY TO A LUXURY HOME

square footage

total heated: 2,654 sq. ft.
 walk-up attic: 435 sq. ft.
 garage: 506 sq. ft.
 covered outdoor living: 312 sq. ft.
TOTAL UNDER ROOF SQ FT: 3,907 sq. ft.

total heated with bonus: 3,089 sq. ft.

overall dimensions

55' width x 77' depth



OPT. SUNROOM



OPT. MAST. BATH

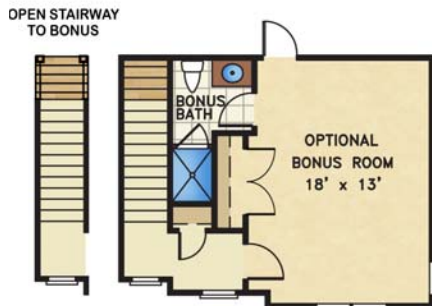

435 sq. ft.



All renderings are the artist's impression of the home. The drawings and square-footage notations are approximate and are only to be used for reference. They should not be relied upon as representations, expressed or implied, of the final detail of the residence.